



trivum RA210

Article-Number: 300011

EAN: 4260393850132

trivum RA410

Article-Number: 300012

EAN: 4260393850125

The trivum RA210 and RA410 are amplifiers for DIN rail mounting with an output power of 2x 20 watt (RA210) or 2x 40 watt (RA410) at 4 ohm.

The volume is continuously adjustable via a universal 0-10 V interface (Volume Control). If the amplifier is used in combination with a trivum audio actuator (RP models of REG product line), so the audio actuator takes over the volume control.

The trivum RA210 and RA410 can also be used as a universal amplifier.



Amplifier

A digital amplifier with closed loop technology and a high efficiency of >90% provides sufficient power and yet remains cool.



Volume Control

The Volume Control interface allows the continuous volume control through audio actuators with 0–10V control output such as RP311 or RP341.



Function

Universal amplifier with an output power of 2x 20 watt (RA210) and 2x 40 watt (RA410) for the operation of an additional zone on the Line-Out output of trivum REG audio actuators RP010, RP311 or RP341.

Case

Material	ABS plastic
Color	grey
Width	3 TE (53 mm)
Total weight	110 g
Mounting	DIN rail

Connections

Ethernet	-
Radio	-
Line-In (analog) (unbalanced)	4-pin terminal block (x1)
Line-In (analog) (balanced)	-
Line-Out (analog)	-
Volume Control	4-pin terminal block (x1)
Control In	4-pol terminal block (x1)
Speaker	4-pin terminal block (x1)

Amplifier

Typ	Class D
Music power (total)	
RA210	40 W @ 4 Ω
RA410	80 W @ 4 Ω
Music power (per channel)	
RA210	20 W @ 4 Ω (x2)
RA410	40 W @ 4 Ω (x2)
Impedance	4–8 Ω
Operating temperature	-20...+50 °C

Power supply

Input voltage	24 V DC
Input current	
RA210	2 A
RA410	4 A
Max. power consumption	
RA210	48 W
RA410	96 W
Stand-by power	
RA210	< 2.5 W
RA410	< 2.5 W
Power supply	not included in the scope of delivery
Connector	2-pin terminal block (x1)





Connection example

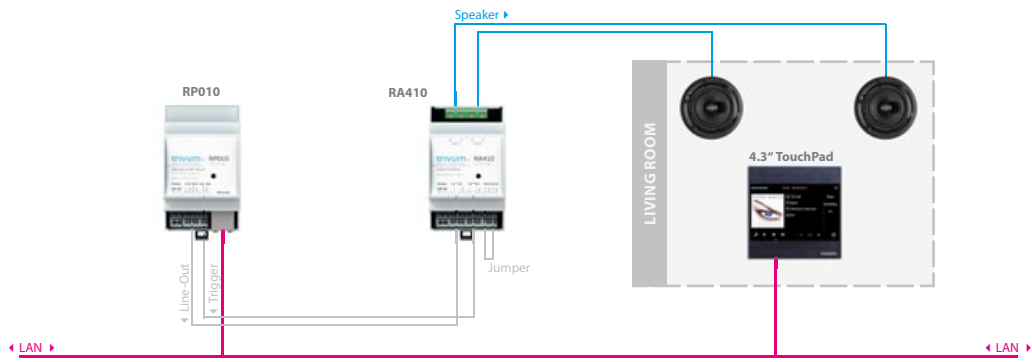

Dimensions

All measurements are given in millimeter (mm).

